

B-468-3160M3A

Visible Light Emitting Diode

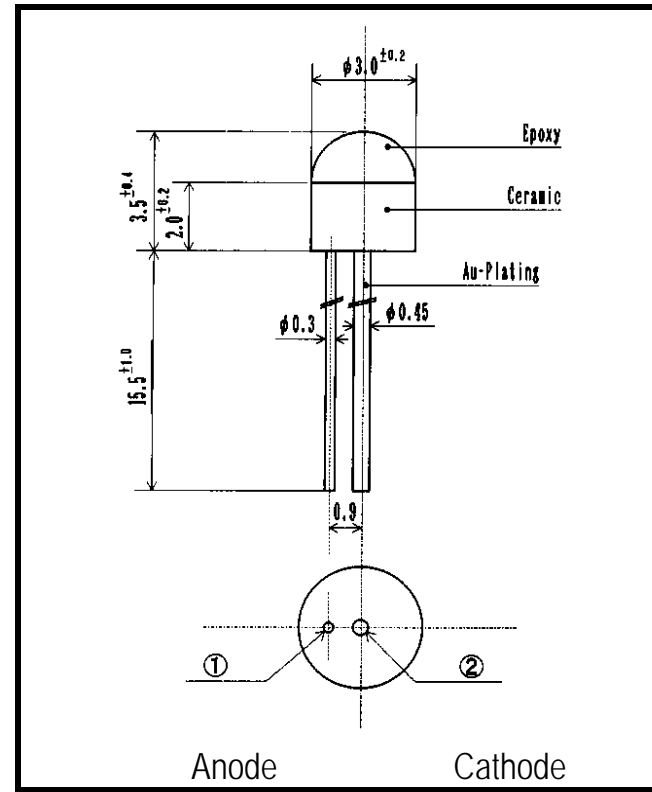

- FEATURES**
- High-output Power
 - Wide Viewing Angle
 - Compact
- APPLICATIONS**
- Display
 - Indicators
 - Light-source for Sensor
 - Optical Switches

1. ABSOLUTE MAXIMUM RATINGS(Ta=25 °C)

| ITEM | SYMBOL | RATINGS | UNIT |
|---------------------------|--------|------------|------|
| Forward Current (DC) | IF | 20 | mA |
| Forward Current (Pulse)*1 | IFP | 0.2 | A |
| Reverse Voltage | VR | 5 | V |
| Power Dissipation | PD | 80 | mW |
| Operating Temp. | Topr | -20 TO 80 | |
| Storage Temp. | Tstg | -30 TO 100 | |
| Junction Temp. | Tj | 100 | |
| Lead Soldering Temp.*2 | Tls | 260 | |

*1:Tw=10uS,T=10mS

*2:Time 3 Sec max,Position:Up to 2mm from the body

2.ELECTRICAL & OPTICAL CHARACTERISTICS (Ta=25 °C)

| ITEM | SYMBOL | CONDITIONS | MIN | TYP | MAX | UNIT |
|---------------------------|--------|------------|-----|------|-----|------|
| Power Output | PO | IF=20mA | 1.3 | 2.5 | | mW |
| Forward Voltage | VF | IF=20mA | | 3.5 | 4.0 | V |
| Reverse Current | IR | VR=5V | | | 100 | μA |
| Peak Wavelength | p | IF=20mA | | 468 | | nm |
| Spectral Line Half Width | | IF=20mA | | 35 | | nm |
| Half Intensity Beam Angle | | IF=20mA | | ±80 | | deg. |
| Rise Time | Tr | IFP=20mA | | - | | nS |
| Fall Time | Tf | IFP=20mA | | - | | nS |
| Junction Capacitance | Cj | 1MHz ,V=0V | | 40 | | pF |
| Temp. Coefficient of PO | P/T | IF=10mA | | -0.5 | | %/ |
| Temp. Coefficient of VF | V/T | IF=10mA | | -3.0 | | mV/ |

Anode Cathode
Dimensions (Unit:mm)

SPECTRAL OUTPUT

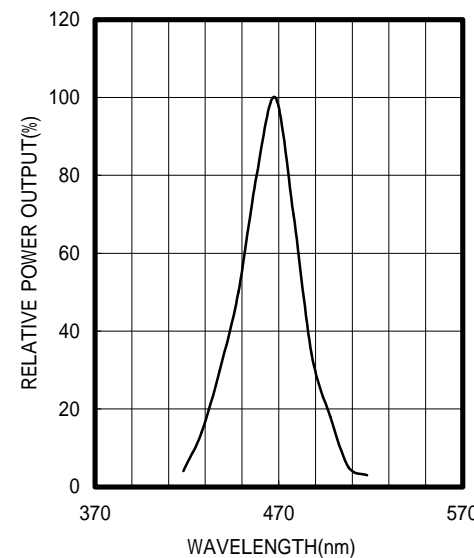

FORWARD I-V CHARACTERISTICS

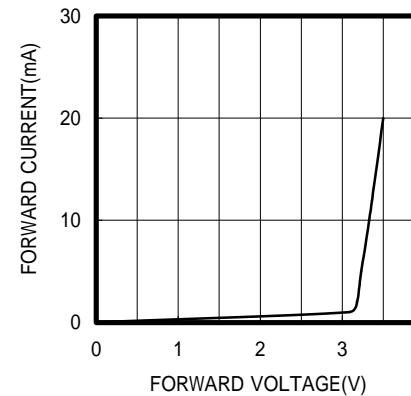

RELATIVE POWER vs FORWARD CURRENT

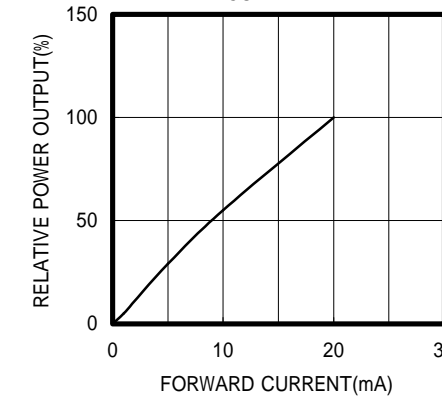

RADIATION PATTERN

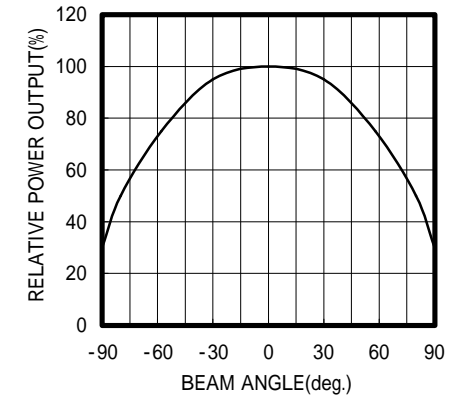

THERMAL DERATING CURVE

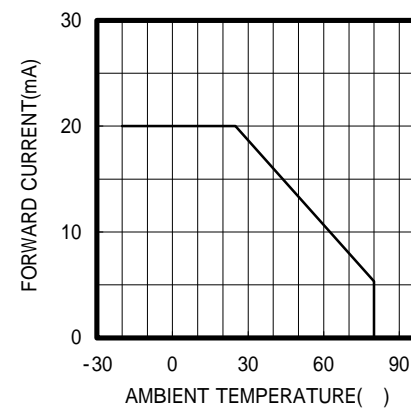

POWER OUTPUT vs TEMPERATURE IF=10mA

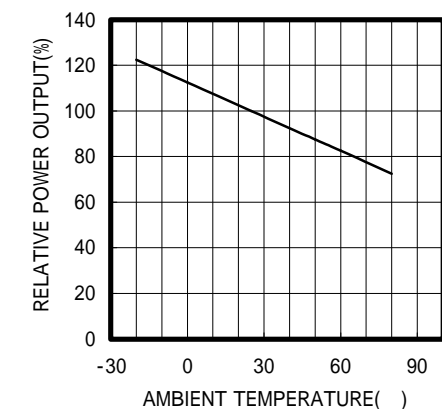

FORWARD VOLTAGE vs TEMPERATURE IF=10mA

